

WLP700/300-MR TANK SPECIFICATIONS

DIMENSIONS:

WALL: 2 1/2"
BOTTOM: SEPTIC 3"

COVER: 4"
MANHOLE: 24" I.D. PRECAST CONCRETE RISER
HEIGHT: FLAT COVER 53 1/4" O.D.
LENGTH: 104" O.D.
WIDTH: 86" O.D.
BELOW INLET: 42" O.D.
LIQUID LEVEL: 36"
WEIGHT: 6,790 LBS.

INLET AND OUTLET:

4" CAST-A-SEAL BOOT OR EQUAL
GASKET, CAST-A-SEAL BOOT OR EQUAL

INLET AND OUTLET Baffle AND FILTER:

WISCONSIN, SEE DETAIL #10
(OTHER STATES SEE CHART)

LIQUID CAPACITY: 26.79 GAL/IN

HOLDING TANK:

OUTLET HOLE PLUGGED
ACTUAL CAPACITY: 1,085 GALLONS

LOADING DESIGN: 8' 0" UNSATURATED SOIL

TANK CAN BE USED AS:
SEPTIC/ HOLDING

COVER: MIX DESIGN #8 (NO FIBER)
TANK: MIX DESIGN #10 (STRUCTURAL FIBER)

CUSTOMIZED TANKS:
FOR CUSTOM TANKS CONTACT WIESER CONCRETE

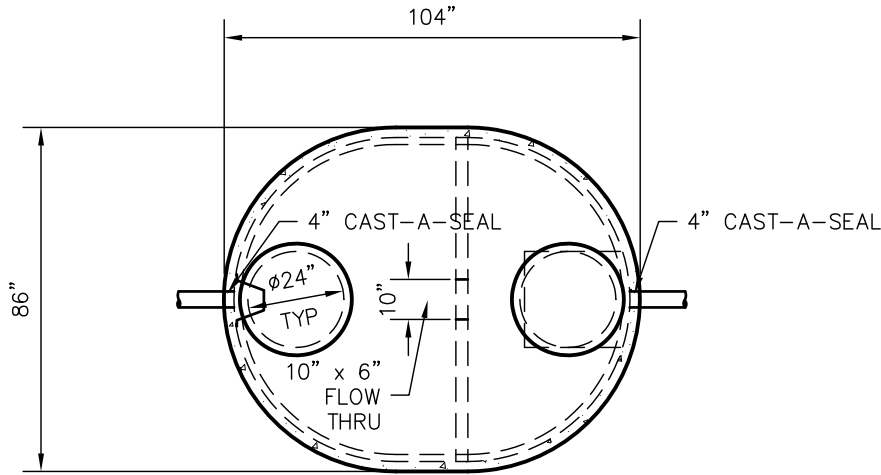

TOP VIEW

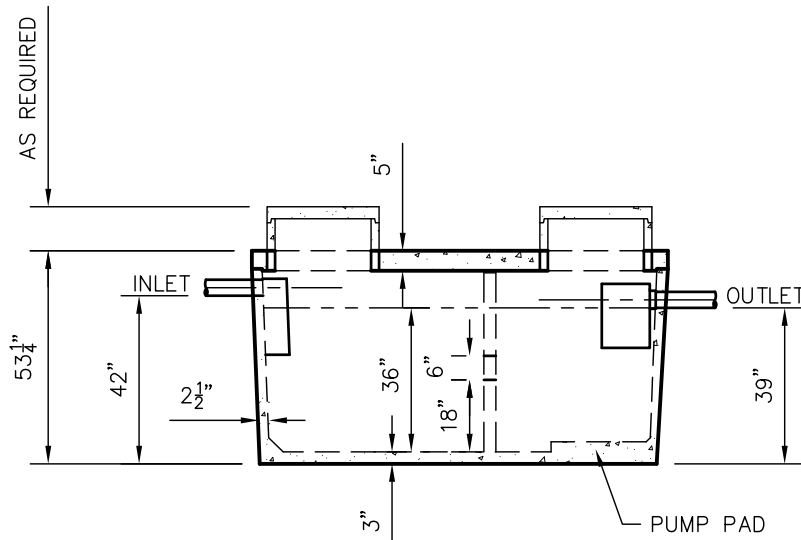

SIDE VIEW

TANKS ARE MANUFACTURED TO MEET OR EXCEED ASTM C-1227 REQUIREMENTS

**DRAWINGS SUBMITTED
FOR APPROVAL**

APPROVED BY: _____
APPROVAL DATE: _____
PRODUCTS NEEDED BY: _____

SHEET NO.

1
OF
1

WLP700/300-MR
SEPTIC MANUAL

WIESER CONCRETE
W3716 US HWY 10 MAIDEN ROCK, WI 54750

800-325-8456

DRAWN BY: WCP

DATE: 00/00/00

FILE: WLP1000-MR

SCALE: 1/4"=1'-0"

REV. DATE:

PRE-POUR: POST-POUR: