

WLP3000 GREASE INTERCEPTOR TANK SPECIFICATIONS

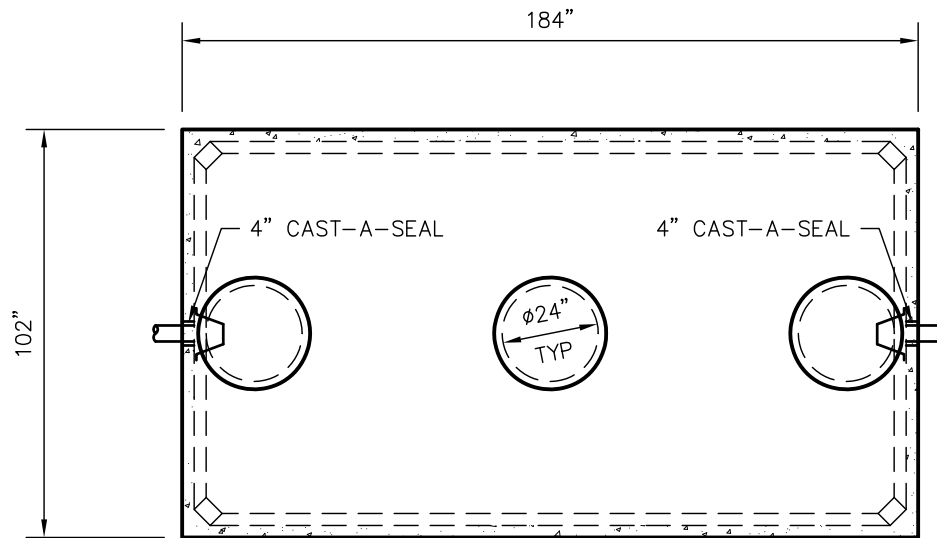

TOP VIEW

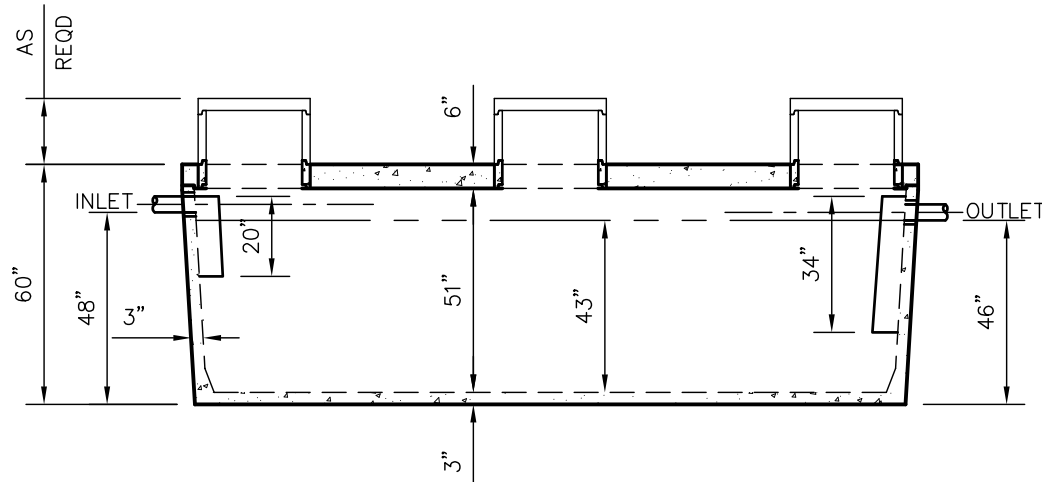

SIDE VIEW

DIMENSIONS:

- WALL: 3"
- BOTTOM: 3"
- COVER: 6"
- MANHOLE: 24" I.D. PRECAST CONCRETE RISER
- HEIGHT: 60 3/4" O.D.
- LENGTH: 184" O.D.
- WIDTH: 102" O.D.
- BELOW INLET: 48" O.D.
- LIQUID LEVEL: 43"
- WEIGHT: TANK 13,013 LBS.
COVER 9,300 LBS.

INLET AND OUTLET:
4" CAST-A-SEAL BOOT OR EQUAL

INLET AND OUTLET BAFFLE:
AS SHOWN

LIQUID CAPACITY: 69.77 GAL/IN

LOADING DESIGN: 8' 0" UNSATURATED SOIL

TANK CAN BE USED AS:
GREASE INTERCEPTOR

COVER: MIX DESIGN #8 (NO FIBER)
TANK: MIX DESIGN #9 (SMALL FIBER)

CUSTOMIZED TANKS:
FOR CUSTOM TANKS
CONTACT WIESER CONCRETE

TANKS ARE MANUFACTURED TO MEET OR EXCEED ASTM C-1227 REQUIREMENTS

DRAWINGS SUBMITTED FOR APPROVAL	
APPROVED BY: _____	PRE-FOUR: _____
APPROVAL DATE: _____	SCALE: 1/4"=1'-0"
PRODUCTS NEEDED BY: _____	REV. _____
	DATE: _____
	POST-POUR: _____

WIESER CONCRETE	W3716 US HWY 10 MAIDEN ROCK, WI 54750
800-325-8456	FILE: WLP3000G
WLP3000GI	SEPTIC MANUAL
SHEET NO.	
1 OF 1	