

# WLP1250-P GREASE INTERCEPTOR TANK SPECIFICATIONS

## DIMENSIONS:

WALL: 3"  
 BOTTOM: 3"  
 COVER: 6"  
 MANHOLE: 24" I.D. PRECAST CONCRETE RISER  
 HEIGHT: 53" O.D.  
 LENGTH: 120" O.D.  
 WIDTH: 81-5/8" O.D.  
 BELOW INLET: 41" O.D.  
 LIQUID LEVEL: 36"  
 WEIGHT: 11,888 LBS.

## INLET AND OUTLET:

4" CAST-A-SEAL BOOT OR EQUAL

## INLET AND OUTLET BAFFLES: AS SHOWN

LIQUID CAPACITY: 34.98 GAL/IN

LOADING DESIGN: 8' 0" UNSATURATED SOIL

TANK CAN BE USED AS:  
GREASE INTERCEPTOR

COVER: MIX DESIGN #8 (NO FIBER)  
 TANK: MIX DESIGN #9 (SMALL FIBER)

CUSTOMIZED TANKS:  
 FOR CUSTOM TANKS CONTACT WIESER CONCRETE

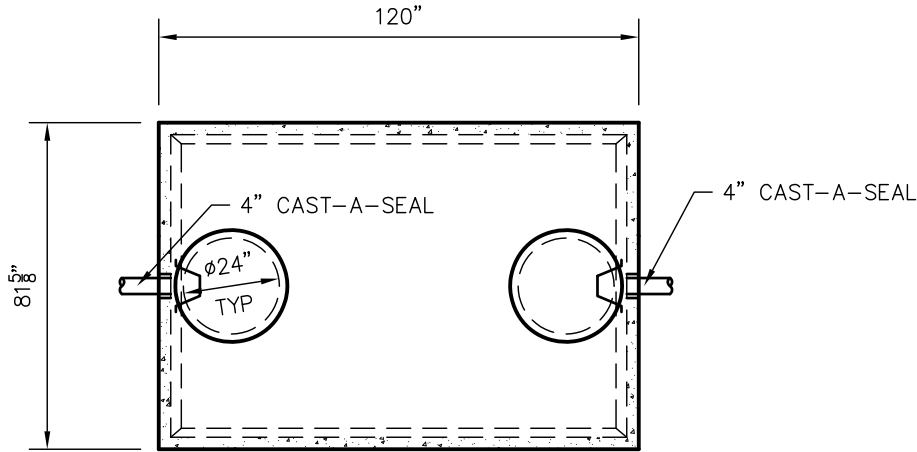

TOP VIEW

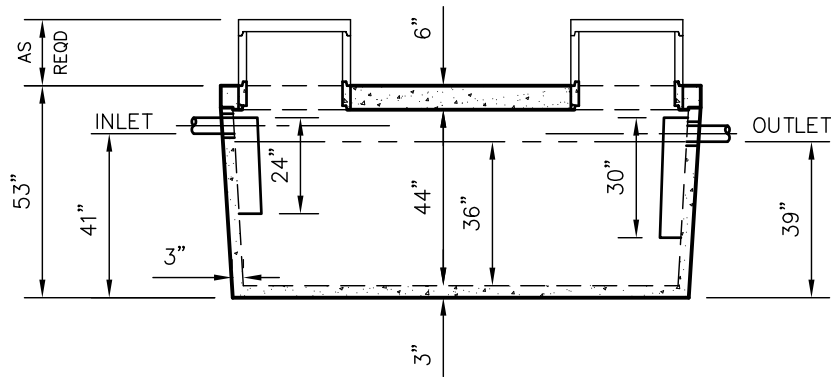

SIDE VIEW

TANKS ARE MANUFACTURED TO MEET OR EXCEED ASTM C-1227 REQUIREMENTS

**DRAWINGS SUBMITTED  
FOR APPROVAL**

APPROVED BY: \_\_\_\_\_  
 APPROVAL DATE: \_\_\_\_\_  
 PRODUCTS NEEDED BY: \_\_\_\_\_

SHEET NO.  
 1 OF 1

DRAWN BY: WCP  
 DATE: 00/00/00  
 FILE: WLP1250G-P

**WIESER CONCRETE**  
 W3716 US HWY 10 MAIDEN ROCK, WI 54750  
 800-325-8456

WLP1250GI-P  
 SEPTIC MANUAL

PRE-POUR:  
 POST-POUR:

SCALE: 1/4"=1'-0"  
 REV. NO. 1  
 DATE: 12-22-14