

# WEHD3000 TANK SPECIFICATIONS

**DIMENSIONS:**

WALL: 6"  
 BOTTOM: 6"  
 COVER: 6"  
 MANHOLE: 24" I.D. PRECAST CONCRETE RISER  
 HEIGHT: 87" O.D.  
 LENGTH: 156" O.D.  
 WIDTH: 84" O.D.  
 BELOW INLET: 75" O.D.  
 LIQUID LEVEL: 67"  
 WEIGHT: 15,700 LBS. PER SECTION

**INLET AND OUTLET:**  
 4" CAST-A-SEAL BOOT, GASKET OR EQUAL

**INLET AND OUTLET BAFFLE AND FILTER:**  
 WISCONSIN, SEE DETAIL #10  
 (OTHER STATES SEE CHART)

**LIQUID CAPACITY:** 44.88 GAL/IN

**LOADING DESIGN:** 12' 0" UNSATURATED SOIL / HS-20

**HOLDING TANK:**  
 OUTLET HOLE PLUGGED  
 ACTUAL CAPACITY: 3,097 GALLONS

**TANK CAN BE USED AS:**  
 SEPTIC / HOLDING / PUMP OR SIPHON

**TANK:** MIX DESIGN #8 (NO FIBER)

**CUSTOMIZED TANKS:**  
 FOR CUSTOM TANKS CONTACT WIESER CONCRETE

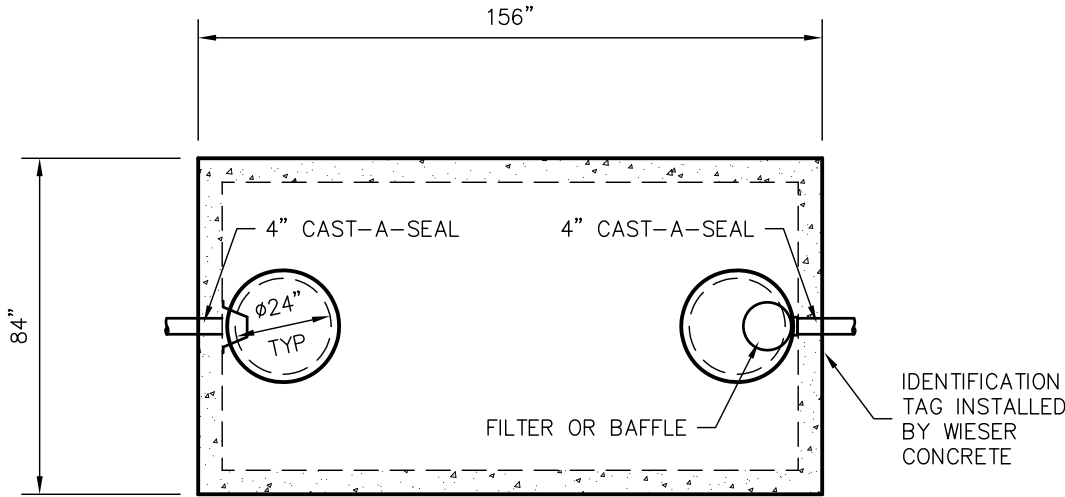

TOP VIEW

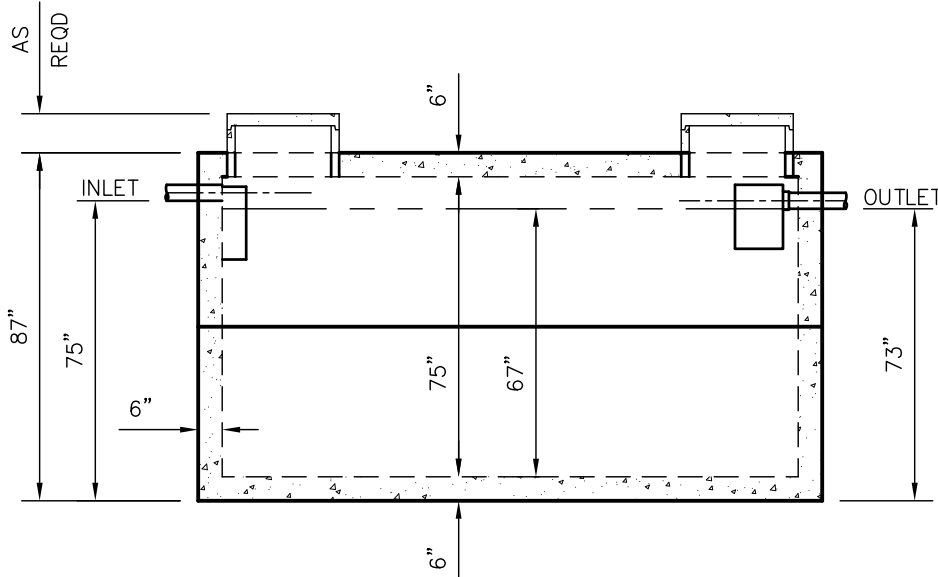

SIDE VIEW

TANKS ARE MANUFACTURED TO MEET OR EXCEED ASTM C-1227 REQUIREMENTS

**DRAWINGS SUBMITTED  
FOR APPROVAL**

APPROVED BY: \_\_\_\_\_  
 APPROVAL DATE: \_\_\_\_\_  
 PRODUCTS NEEDED BY: \_\_\_\_\_

PRE-POUR:  
POST-POUR:

SCALE: 1/4"=1'-0"  
REV. \_\_\_\_\_  
DATE: \_\_\_\_\_

DRAWN BY: WCP  
DATE: 00/00/00

FILE: WEHD3000

**WIESER CONCRETE**  
 W3716 US HWY 10 MAIDEN ROCK, WI 54750  
 800-325-8456

WEHD3000  
 SEPTIC MANUAL

SHEET NO.  
 1 OF 1