

TOP VIEW

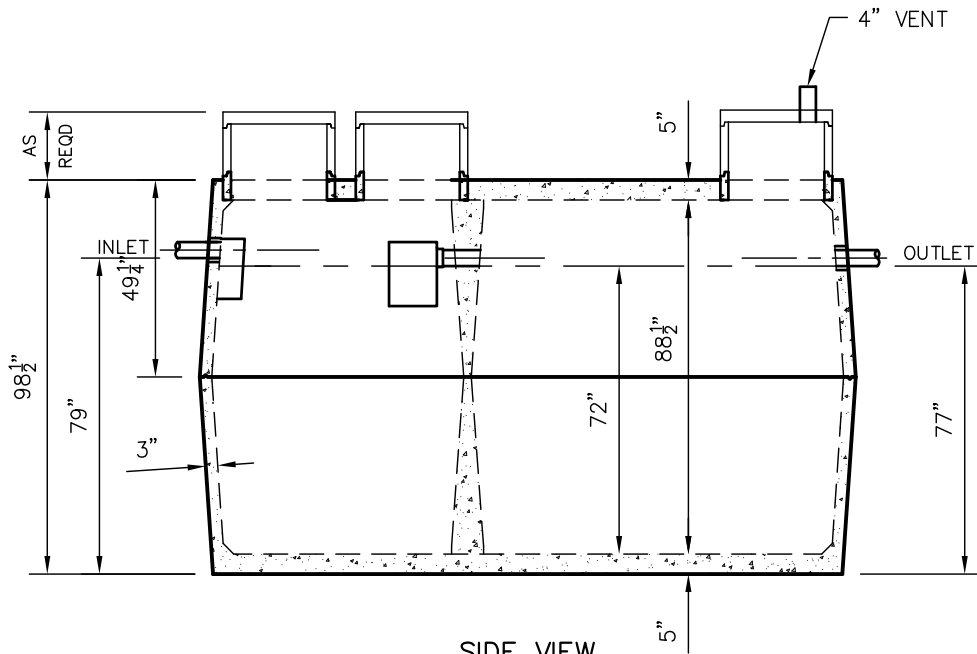

SIDE VIEW

TANKS ARE MANUFACTURED TO MEET OR EXCEED ASTM C-1227 REQUIREMENTS

W1650/2500 TANK SPECIFICATIONS

DIMENSIONS:

WALL: 3"
 BOTTOM: 5"
 COVER: 5"
 MANHOLE: 24" I.D. PRECAST CONCRETE RISER
 HEIGHT: 98-1/2" O.D.
 LENGTH: 164" O.D.
 WIDTH: 96" O.D.
 BELOW INLET: 79" O.D.
 LIQUID LEVEL: 72"
 WEIGHT: 13,200 LBS PER SECTION

INLET AND OUTLET:
 4" CAST-A-SEAL BOOT OR EQUAL

INLET AND OUTLET BAFFLE AND FILTER:
 WISCONSIN, SEE DETAIL #10
 (OTHER STATES SEE CHART)

LIQUID CAPACITY: 22.89 GAL/IN (SEPTIC)
 34.53 GAL/IN (PUMP)

HOLDING TANK:
 OUTLET HOLE PLUGGED
 ACTUAL CAPACITY: 4,134 GALLONS

LOADING DESIGN: 8'-0" UNSATURATED SOIL

TANK CAN BE USED AS:
 SEPTIC/SEPTIC, SEPTIC/PUMP, SEPTIC/SIPHON
 OR HOLDING

TANK: MIX DESIGN #9 (SMALL FIBER)

**DRAWINGS SUBMITTED
FOR APPROVAL**

APPROVED BY: _____
 APPROVAL DATE: _____
 PRODUCTS NEEDED BY: _____

PRE-POUR:
POST-POUR:

SCALE: 1/4"=1'-0"
REV. DATE:

DRAWN BY: WCP
DATE: 00/00/00

FILE: W1650/2500

WIESER CONCRETE
 W3716 US HWY 10 MAIDEN ROCK, WI 54750
 800-325-8456

W4200
SEPTIC MANUAL

SHEET NO.
1 OF 1